



PS

PS2/AN-0C

Photo.Min, NPN-NO, Cable 90°, Diffuse
DC MINIATURIZED CUBIC PHOTOELECTRIC SENSORS

OVERVIEW

- Wide range of models: diffuse, retro-reflective, through-beam
- Extremely reduced dimensions
- High sensing distance
- Sensitivity adjustment
- Standard cable exit or M12 plug exit
- LED status indicator
- IP65 protection degree
- Complete protection against electrical damage



TECHNICAL FEATURES

Detection properties

Nominal sensing distance	100mm
Thermal drift of Sr	$\leq 10\%$ Sr
Repeat Accuracy	$\leq 5\%$
Sensitivity adjustment	Trimmer

Application

Function Principle	Diffuse reflection (short distance, $\leq 200\text{mm}$)
--------------------	---

Optic position	Axial
----------------	-------

Outputs

Output type	NPN NO
-------------	--------

Output Function	NO
-----------------	----

Switching frequency	100Hz
---------------------	-------

Response time	5ms
---------------	-----

Electrical data

Operating Voltage	10...30VDC
-------------------	------------

No-Load supply current	$\leq 30\text{mA}$
------------------------	--------------------

Load current	$\leq 100\text{mA}$
--------------	---------------------

Leakage current	$\leq 10\mu\text{A}$ @ V_{max}
-----------------	---

Output voltage drop	$\leq 1,2\text{V}$ @ $I_{\text{load}}=100\text{mA}$
---------------------	---

Max ripple content	$\leq 10\%$
--------------------	-------------

LED indicators	red (output state)
----------------	--------------------

Time delay before availability	$\leq 200\text{ms}$
--------------------------------	---------------------

Short-circuit protection	Yes
--------------------------	-----

Reverse Polarity Protection	Yes
-----------------------------	-----

Emission	LED Infrared (880nm)
Interference to external light	3000lux Incandescent Lamp, 10000lux

Mechanical data

Dimensions	15x49x26mm
Material	
Housing material	ABS
Weight	90g
Connections	2m PVC cable 90°
Active Head Material	PMMA
Operating temperature	- 25°C...+ 70°C (without freeze)
Diameter/Dimension	Cubic

Test/Approvals

Approvals	CE
EMC compatibility	EN 60947-5-2
Shocks and vibrations	Vibration IEC 60068-2-6 / Shock IEC 60068-2-27
Degree of protection	IP65

Accessories

Supplied Accessories	ST07 mounting bracket and screws
----------------------	----------------------------------

Generical Data

Dimensions 15x49x26mm

Operating Temperature - 25°C...+ 70°C (Without freeze)

Mechanical Protection IP65

CONNECTIONS

Electrical diagram

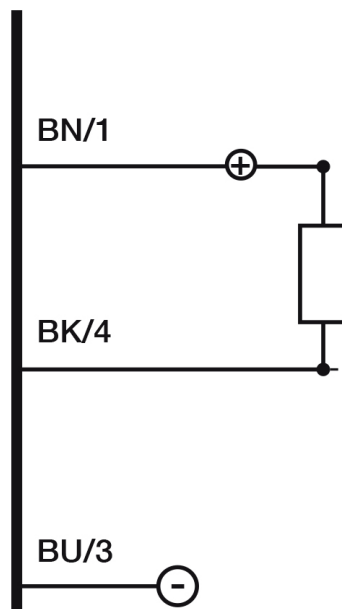

OTHERS

Dimensions

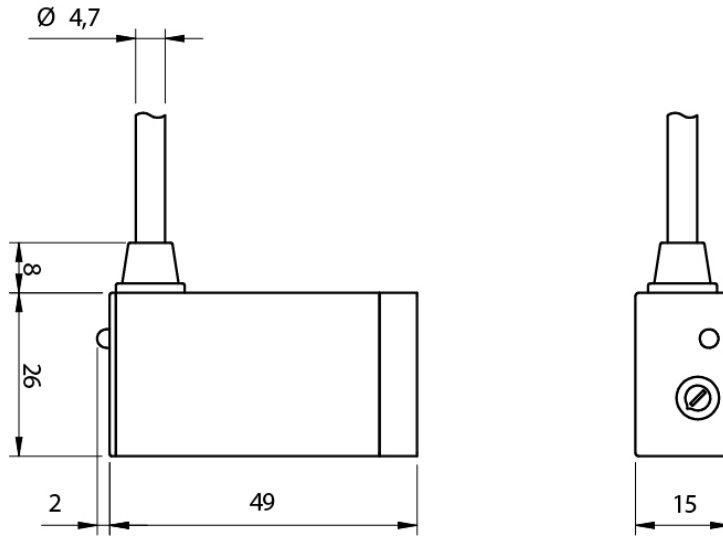
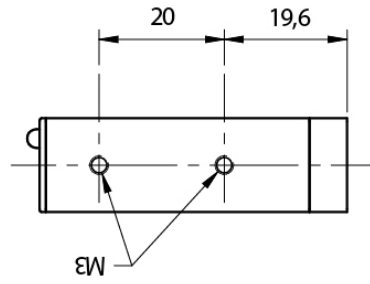

Response curves

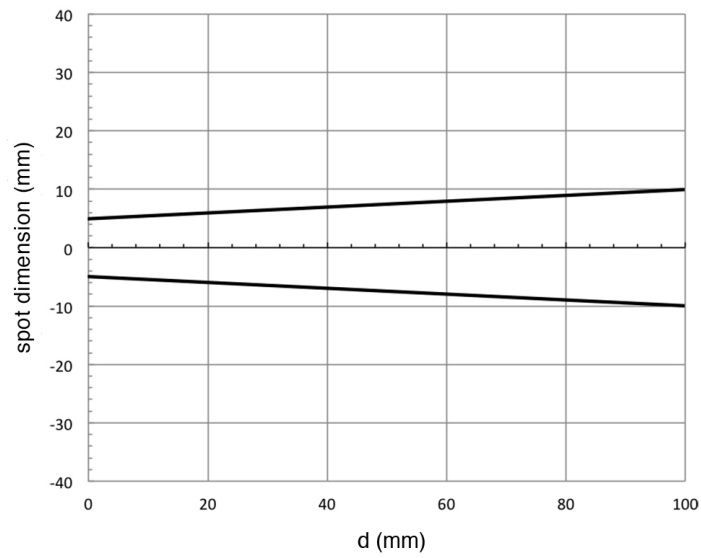

**Datasensing
S.r.l.**

Strada S.Caterina, 235
41122 Modena (MO)
Tel. 059 420411

**date of
printing**
14/06/2026
02:04:25

Fax 059 253973

E-mail

info@datasensing.com