



SH/TH

SH2/R-3EIC

Safety, M18, Receiver, M12 plug, Type 2
PHOTOCELLS TYPE 2 AND TYPE 4

OVERVIEW

- M18 Models 10 m (axial optic) and 5 m (radial optic) operating distance
- M30 models 60 m operating distance
- EN50100 Category 2 and Category 4 compliant
- LED indicators
- Plastic and Metal Housing
- Inputs and Outputs IEC61131-2 compliant and adaptable with any safety module
- To be used together with a Category 2 or Category 4 safety control unit to obtain a safety system EN ISO 13849 compliant



TECHNICAL FEATURES

Detection properties

Nominal sensing distance	5m (ExG=2)
--------------------------	------------

Thermal drift of Sr	≤ 10%
---------------------	-------

Resolution	Single-beam
------------	-------------

controlled height	Single-beam
-------------------	-------------

Effective Aperture Angle	$\leq \pm 5^\circ$
Effective Aperture Angle	Typical $\pm 1,8^\circ$

Application

Function Principle	Receiver
Notes	not working with SBCR03 control unit. To be used with external safety control unit with automatic optics test function
Description	M18 Type 2 Safety Photocell Receiver

Safety parameters

Type	Type 2 safety photocell
SIL	1
SILCL	1
PL	c
PFHd	1,00E-06
MTTFd	20 years

Outputs

Output type	Totem-pole
Resposnse time for light/dark transition	200 μ s
Resposnse time for dark/light transition	400 μ s

Electrical data

||
||
||

Operating Voltage	10 ... 30 Vdc
No-Load supply current	≤ 25mA
Load current	≤ 70mA
Output voltage drop	2,5V @ 50mA
Max ripple content	≤ 5 Vpp
LED indicators	Yellow (alignement)

Mechanical data

Dimensions	M18
Housing Material	PBT
Connections	M12 plug
Active Head Material	Glass
Operating temperature	-20°C ... +55°C
Storage temperature	-40°C ... +75°C
humidity	15% ... 95%

Test/Approvals

Approvals	CE, TÜV
Shocks and vibrations	10g - 16ms (according to IEC600068-2-29) 10Hz...55Hz - 1 oct/min - 0,35mm (according to 60068-2-6)
Degree of protection	IP67

Accessories

Supplied Accessories	2 x nuts
----------------------	----------

Generical Data

Dimensions	M18
Operating Temperature	-20...+55°C (Without freeze)
Humidity	15% ... 95%
Mechanical Protection	IP67

CONNECTIONS

Eletrical diagram

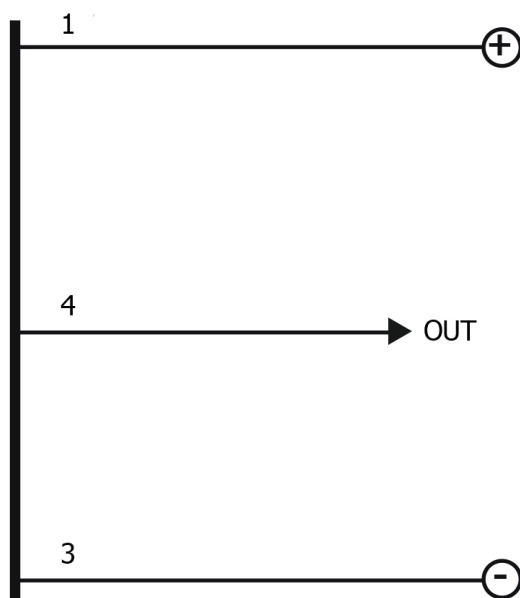

Connector

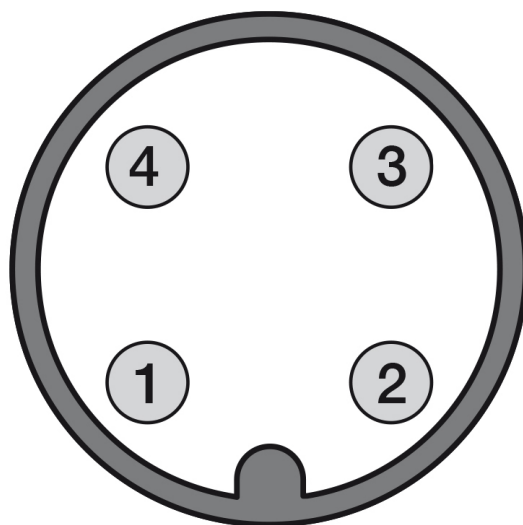

OTHERS

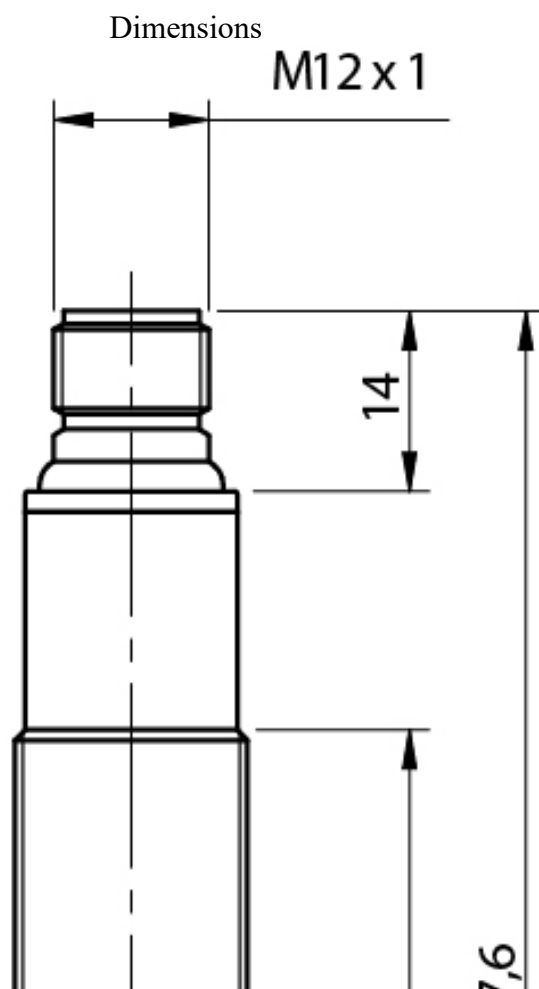

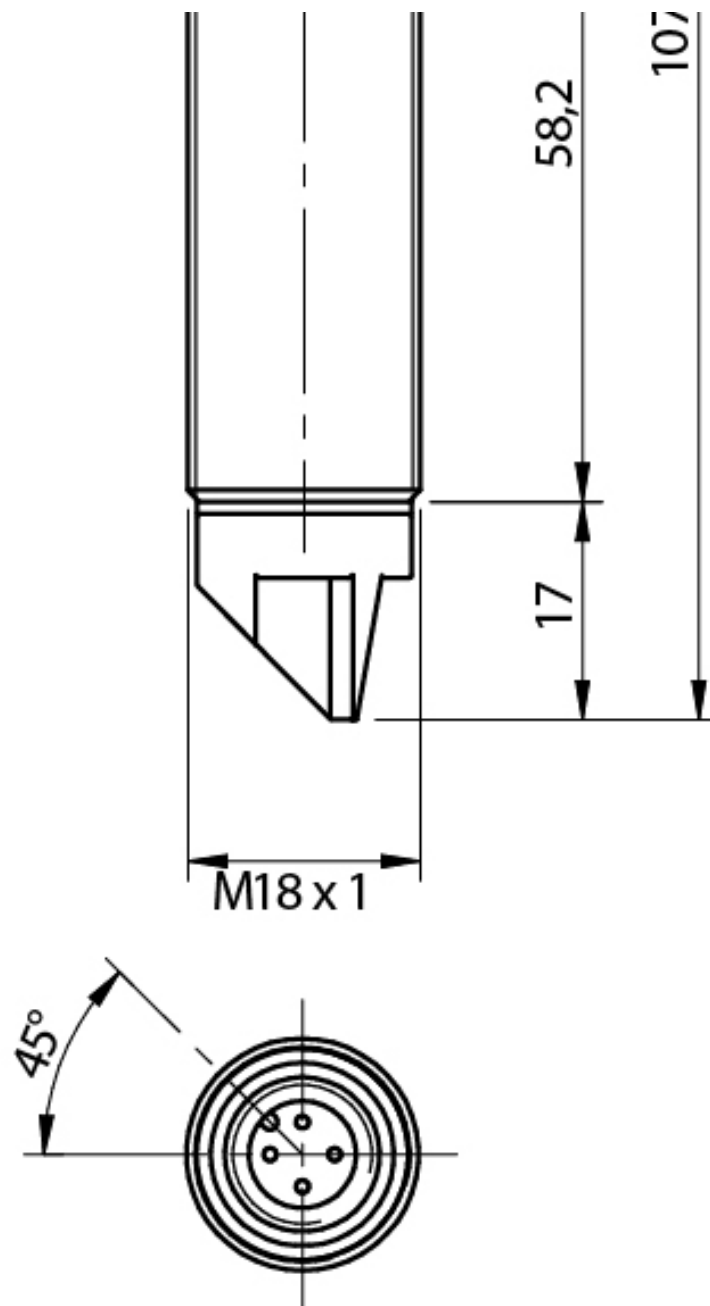

**Datasensing
S.r.l.**

Strada S.Caterina, 235
41122 Modena (MO)
Tel. 059 420411
Fax 059 253973
E-mail
info@datasensing.com

**date of
printing**
05/08/2025
10:00:49