

# METAL FACE M12

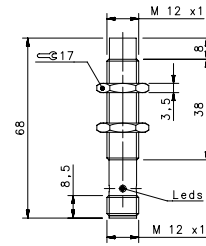
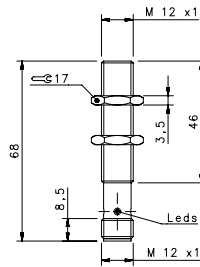

## METAL FACE

				FLUSH	NON FLUSH
				M12 conn	M12 conn
NOMINAL SWITCHING DISTANCE				2 mm	4 mm
10-30 Vdc	PNP/NPN NO-NC	4 wires	order No.	---	---
10-30 Vdc	PNP NO	3 wires	order No.	IS-12-I1-S2 95B065340	IS-12-L1-S2 95B063871
10-30 Vdc	PNP NC	3 wires	order No.	---	---
10-30 Vdc	NPN NO	3 wires	order No.	---	---
10-30 Vdc	NPN NC	3 wires	order No.	---	---
10-30 Vdc	PNP NO-NC	4 wires	order No.	---	---
10-30 Vdc	NPN NO-NC	4 wires	order No.	---	---
10-30 Vdc	NO-NC	2 wires	order No.	---	---
20-250 Vac/Vdc	NO	2 wires	order No.	---	---
20-250 Vac/Vdc	NC	2 wires	order No.	---	---
20-250 Vac	NO	2/3wires	order No.	---	---
10-30 Vdc	Analog 0-20 mA	3 wires	order No.	---	---
NAMUR amplifier	NAMUR	2 wires	order No.	---	---
Nominal Voltage				10-30 Vdc	10-30 Vdc
Residual Ripple				< 10%	< 10%
Hysteresis				< 15%	< 15%
Max. Output Current				200 mA	200 mA
Min. Output Current				---	---
Residual Current				< 0,01 mA	< 0,01 mA
Voltage Drop				< 1,5 V (I=100mA)	< 1,5 V (I=100mA)
Operation Led				Present	Present
Switching Frequency				2000 Hz	1000 Hz
Start Up Delay				---	---
Repeatability				< 1%	< 1%
Short Circuit Protection				Present (self-resetting)	Present (self-resetting)
Electric Protection				Against polarity reversal inductive loads	Against polarity reversal inductive loads
Temperature Limit				(-25 ... +70 °C)	(-25 ... +70 °C)
Protection Degree				IP67	IP67
Cable Length				---	---
Cable Section				---	---
Housing Material				Stainless-Steel	Stainless-Steel
Active face				Stainless Steel AISI 303	Stainless Steel AISI 303
Tightening torque				10Nm	10Nm
Weight - Cable Output				---	---
Weight - Connector Output				30 g	30 g

# METAL FACE M18

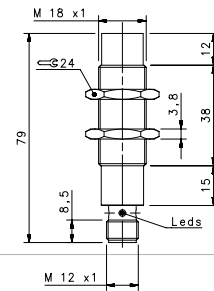
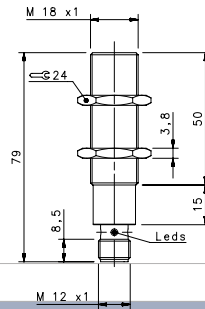

## METAL FACE

### NOMINAL SWITCHING DISTANCE

				FLUSH	NON FLUSH
				M12 conn	M12 conn
				5 mm	8 mm
10-30 Vdc	PNP/NPN NO-NC	4 wires	order No.	---	---
10-30 Vdc	PNP NO	3 wires	order No.	IS-18-I1-S2 95B065350	IS-18-L1-S2 95B063881
10-30 Vdc	PNP NC	3 wires	order No.	---	---
10-30 Vdc	NPN NO	3 wires	order No.	---	---
10-30 Vdc	NPN NC	3 wires	order No.	---	---
10-30 Vdc	PNP NO-NC	4 wires	order No.	---	---
10-30 Vdc	NPN NO-NC	4 wires	order No.	---	---
10-30 Vdc	NO-NC	2 wires	order No.	---	---
20-250 Vac/Vdc	NO	2 wires	order No.	---	---
20-250 Vac/Vdc	NC	2 wires	order No.	---	---
20-250 Vac	NO	2/3 wires	order No.	---	---
10-30 Vdc	Analog 0-20 mA	3 wires	order No.	---	---
NAMUR amplifier	NAMUR	2 wires	order No.	---	---
<b>Nominal Voltage</b>				10-30 Vdc	10-30 Vdc
<b>Residual Ripple</b>				< 10%	< 10%
<b>Hysteresis</b>				< 15%	< 15%
<b>Max. Output Current</b>				200 mA	200 mA
<b>Min. Output Current</b>				> 1,6 mA	> 1,6 mA
<b>Residual Current</b>				< 0,01 mA	< 0,01 mA
<b>Voltage Drop</b>				< 1,5 V	< 1,5 V
<b>Operation Led</b>				Present	Present
<b>Switching Frequency</b>				1000 Hz	500 Hz
<b>Start Up Delay</b>				---	---
<b>Repeatability</b>				< 1%	< 1%
<b>Short Circuit Protection</b>				Present (self-resetting)	Present (self-resetting)
<b>Electric Protection</b>				Against polarity reversal inductive loads	Against polarity reversal inductive loads
<b>Temperature Limit</b>				(-25 ... +70 °C)	(-25 ... +70 °C)
<b>Protection Degree</b>				IP67	IP67
<b>Cable Length</b>				---	---
<b>Cable Section</b>				---	---
<b>Housing Material</b>				Stainless-Steel	Stainless-Steel
<b>Active face</b>				Stainless Steel AISI 303	Stainless Steel AISI 303
<b>Tightening torque</b>				10Nm	10Nm
<b>Weight - Cable Output</b>				---	---
<b>Weight - Connector Output</b>				95g	95g

Stainless Steel housing  
PTFE active face  
Standard length  
Operating distance 2 ... 8 mm  
M12, M18  
M12 connector  
3 wires  
PNP, NO  
IP67 protection

REDUCTION FACTOR

	ALUMINUM (25° C)	STAINLESS STEEL AISI316L	COPPER	BRASS
Average red. Fact.	0,45	0,85	0,4	0,5

